

# Replacing the Stratus portable receiver battery enclosure

Applicable to Stratus 2, 2S, and 3

1. Unscrew the 4 screws from the corners of your receiver using the supplied Torx screwdriver. Punch through the label or peel back the label to access the top 2 screws.



2. Remove the entire bottom enclosure and replace it with the supplied enclosure. Re-align the two enclosures.

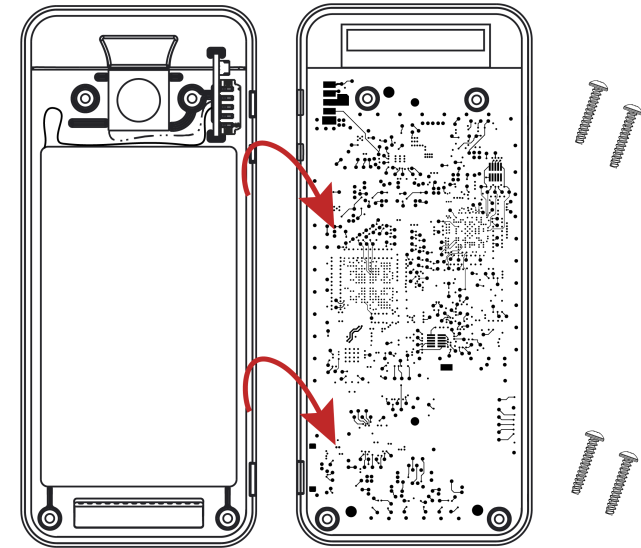

3. Replace the 4 screws and tighten. Do not over-torque: the plastic could strip.

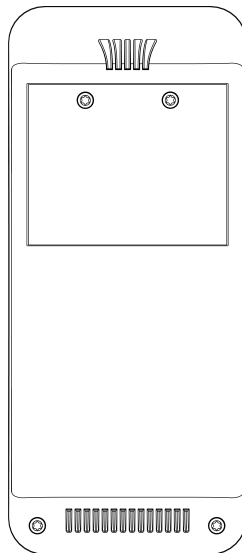

4. Orient the receiver so that the LEDs face you. Remove the backing from the new label that corresponds to your device and apply it to the back of the bottom enclosure.

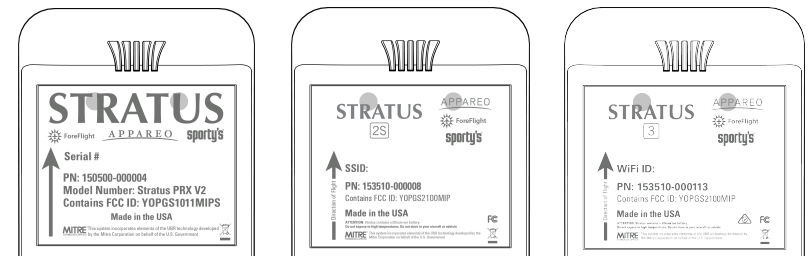

Stratus 2

Stratus 2S

Stratus 3

**Note:** If you have a Stratus 2, replacement enclosures look slightly different around the bottom of the charging port.

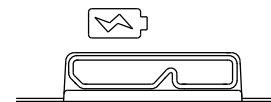

Stratus 2 enclosure

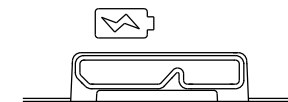

Replacement enclosure